

□ 回路図 : *CIRCUIT*

□ 概略図 : *SCHEMATIC DIAGRAM*

Dimension: [mm]

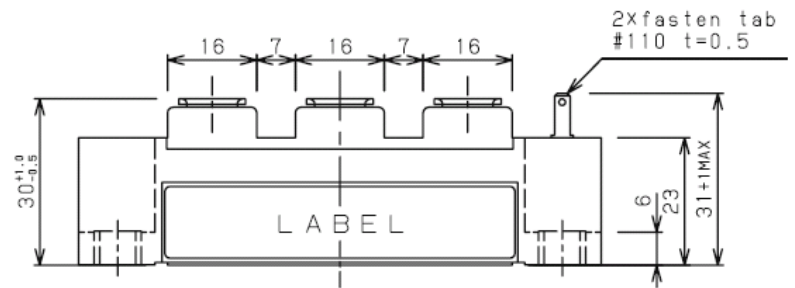
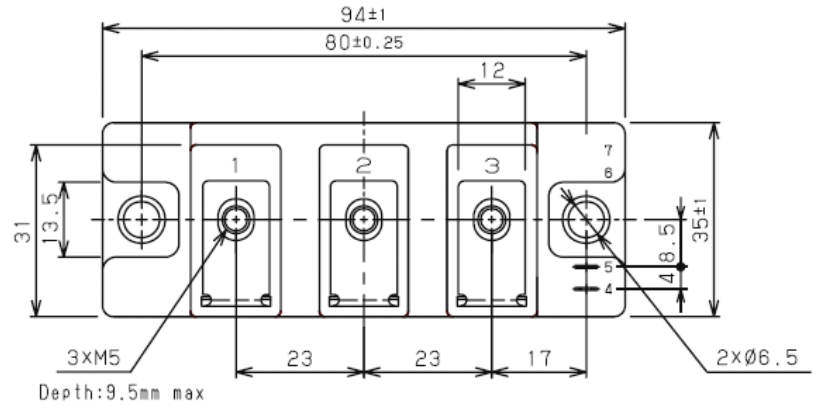
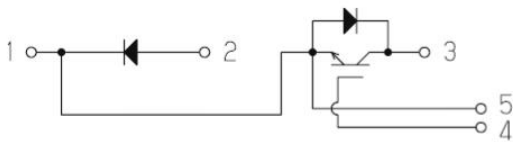

□ 最大定格 : *MAXIMUM RATINGS* (at  $T_c=25^\circ\text{C}$  unless otherwise specified)

	Item	Symbol	Condition	Rated Value	Unit
IGBT	コレクタ・エミッタ間電圧 Collector-Emitter Voltage	$V_{CES}$	G-E Short	1200	V
	ゲート・エミッタ間電圧 Gate-Emitter Voltage	$V_{GES}$	C-E Short	$\pm 20$	V
	コレクタ電流 Collector Current	$I_C$	DC $T_c=85^\circ\text{C}$	100	A
		$I_{CP}$	Pulse $\leq 1\text{ms}$	200	
	コレクタ損失 Collector Power Dissipation	$P_C$	$T_j=175^\circ\text{C}$	483	W
			$T_j=150^\circ\text{C}$	403	
FWD	繰り返しピーク逆電圧 Repetitive peak reverse voltage	$V_{RRM}$		1200	V
	順電流 Forward Current	$I_F$		100	A
		$I_{FM}$	Pulse $\leq 1\text{ms}$	200	
	最大接合温度 Maximum Junction Temperature	$T_{jMAX}$	瞬時動作(過負荷) Instantaneous Overload	175	$^\circ\text{C}$
	接合温度範囲 Junction Temperature Range	$T_j$		$-40\sim+150$	$^\circ\text{C}$
	保存温度範囲 Storage Temperature Range	$T_{stg}$		$-40\sim+125$	$^\circ\text{C}$
	絶縁耐圧 Isolation Voltage	$V_{ISO}$	Terminal to Base AC, 1minute	2,500	V (RMS)
締め付けトルク Mounting Torque	Module Base to Heatsink	$F_{tor}$	M6	3	N·m
	Busbar to Main Terminal		M5	2	

□ 電 氣 的 特 性 : **ELECTRICAL CHARACTERISTICS** (at  $T_J=25^\circ\text{C}$  unless otherwise specified)

Characteristic		Symbol	Test Condition	Min.	Typ.	Max.	Unit	
IGBT	コレクタ遮断電流 Collector-Emitter Cut-Off Current	$I_{CES}$	$V_{CE}=1200V, V_{GE}=0V$	—	—	1.0	mA	
	ゲート漏れ電流 Gate-Emitter Leakage Current	$I_{GES}$	$V_{GE}=\pm 20V, V_{CE}=0V$	—	—	1.0	$\mu\text{A}$	
	コレクタ・エミッタ間飽和電圧 Collector-Emitter Saturation Voltage	$V_{CE(sat.)}$	$I_c=100A, V_{GE}=15V$ (chip level)	$T_J=25^\circ\text{C}$	—	1.50	2.00	V
				$T_J=125^\circ\text{C}$	—	1.70	—	
				$T_J=150^\circ\text{C}$	—	1.80	—	
	ゲートしきい値電圧 Gate-Emitter Threshold Voltage	$V_{GE(th.)}$	$V_{CE}=10V, I_c=3.3mA$	4.8	—	7.0	V	
	入力容量 Input Capacitance	$C_{ies}$	$V_{CE}=25V, V_{GE}=0V, f=1MHz$	—	10.0	—	nF	
	出力容量 Output Capacitance	$C_{oes}$		—	0.30	—		
	帰還容量 Reverse Transfer Capacitance	$C_{res}$		—	0.23	—		
	ゲート電荷量 Gate Charge	$Q_g$	$V_{CC}=600V, I_c=100A, V_{GE}=-15\sim+15V$	—	1100	—	nC	
スイッチング時間 Switching Time	上昇時間 Rise Time	$t_r$	$V_{CC}=600V, L_s=38nH$ $I_c=100A$ Inductive Load $R_g=75\Omega$ $V_{GE}=\pm 15V$ $T_J=150^\circ\text{C}$	—	60	—	ns	
	ターンオン遅延時間 Turn-on Delay Time	$t_d(on)$		—	110	—		
	下降時間 Fall Time	$t_f$		—	190	—		
	ターンオフ遅延時間 Turn-off Delay Time	$t_d(off)$		—	500	—		
順電圧 Peak Forward Voltage	$V_F$	$I_F=100A, V_{GE}=0V$ (chip level)	$T_J=25^\circ\text{C}$	—	2.00	2.60	V	
			$T_J=125^\circ\text{C}$	—	1.98	—		
			$T_J=150^\circ\text{C}$	—	1.95	—		
逆回復時間 Reverse Recovery Time	$t_{rr}$	$V_{CC}=600V, L_s=38nH$ $I_c=100A$ Inductive Load $R_g=75\Omega$ $V_{GE}=\pm 15V$ $T_J=150^\circ\text{C}$	—	170	—	ns		
内部配線抵抗 Internal Lead Resistance	$R_{CC+EE}$	主端子—チップ間 / 1素子 Main Terminal - Chip / Per 1 Arm	—	—	1	$m\Omega$		
内部インダクタンス Stray Inductance	$L_{SCE}$	メイン端子3—2間 Main Terminal 3 - Main Terminal 2	—	30	—	nH		

 □ 熱 的 特 性 : **THERMAL CHARACTERISTICS**

Characteristic		Symbol	Test Condition	Min.	Typ.	Max.	Unit
熱 抵 抗 Thermal Resistance	IGBT	$R_{th(j-c)}$	Junction to Case Per 1 Arm (T <sub>c</sub> 測定点:チップ直下)	—	—	0.31	$^\circ\text{C}/\text{W}$
	FWD			—	—	0.72	
接 触 熱 抵 抗 Thermal Resistance	IGBT	$R_{th(c-f)}$	Case to heatsink Per 1 Arm Paste=1W/(m <sup>2</sup> ·°C)	—	0.10	—	
	FWD			—	0.17	—	

特性图 : CHARACTERISTICS CURVES

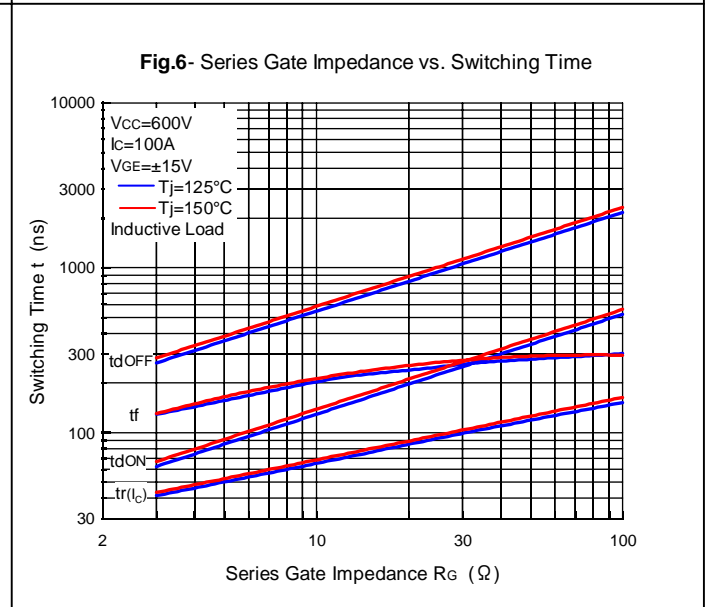
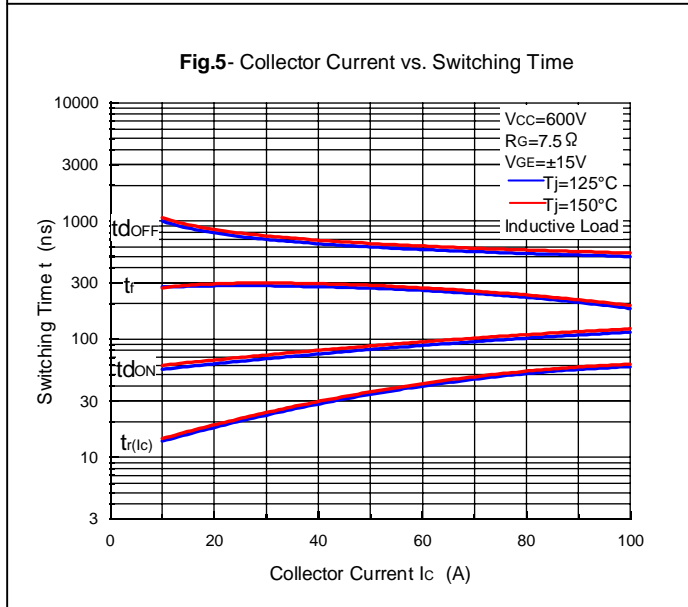
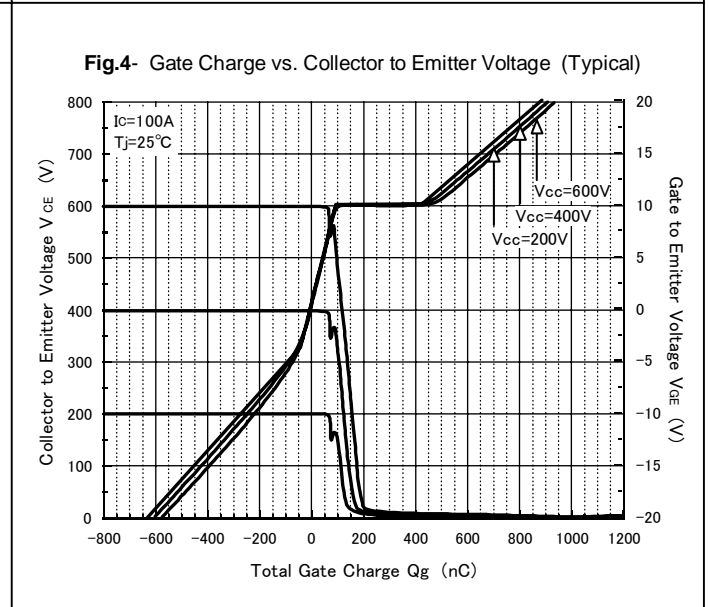
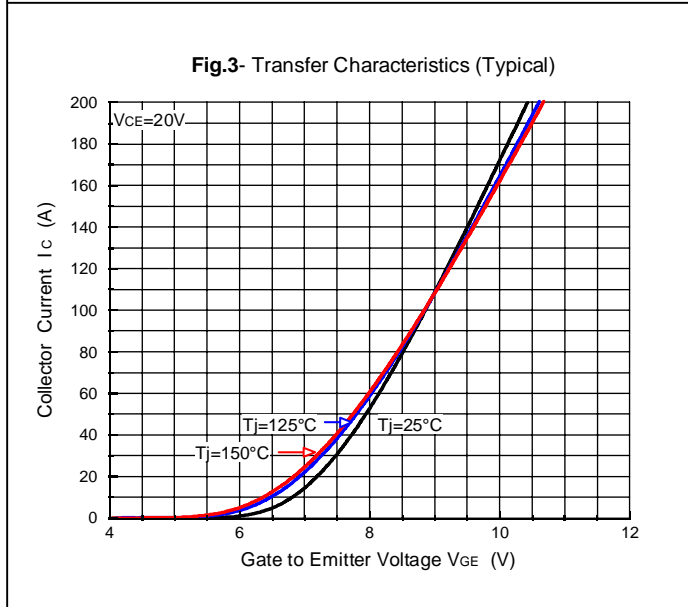
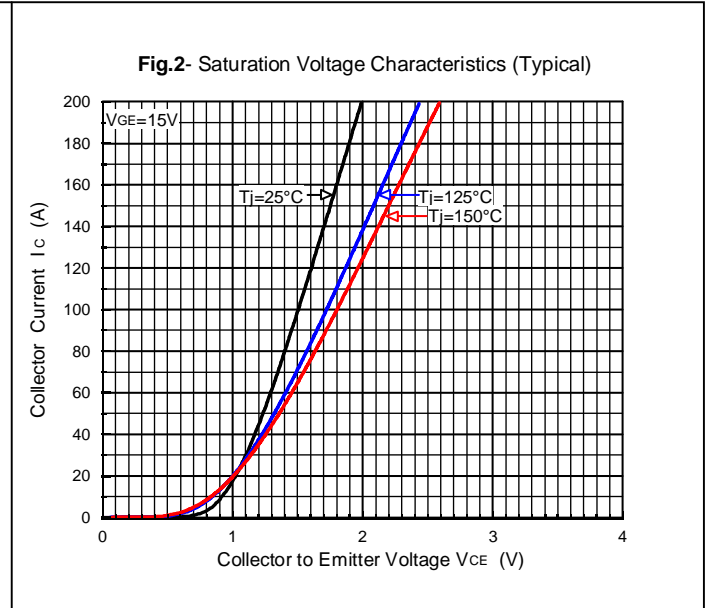
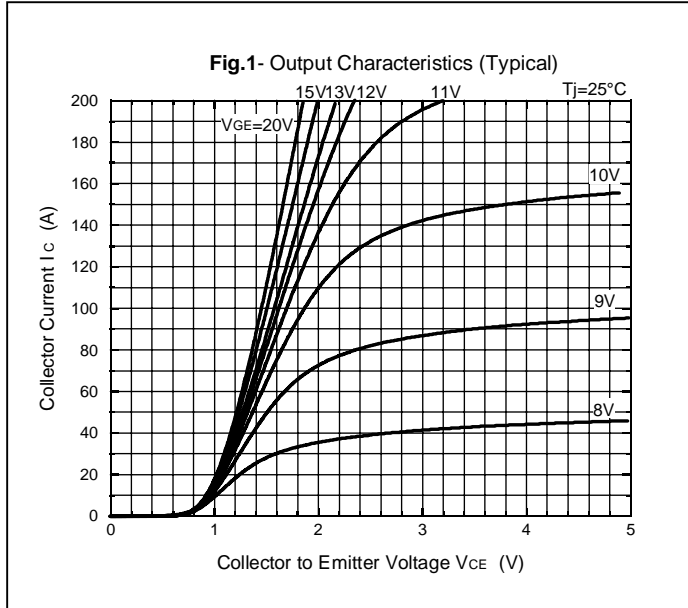

特图 : CHARACTERISTICS CURVES

